

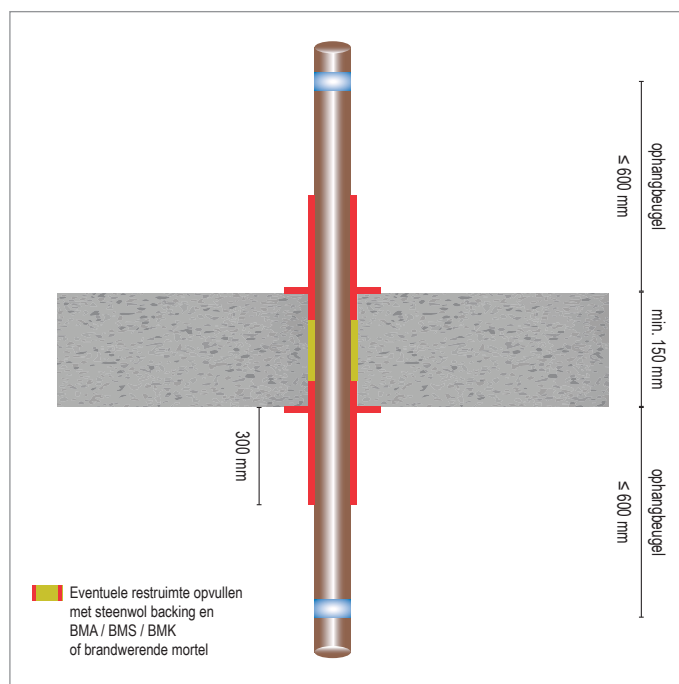

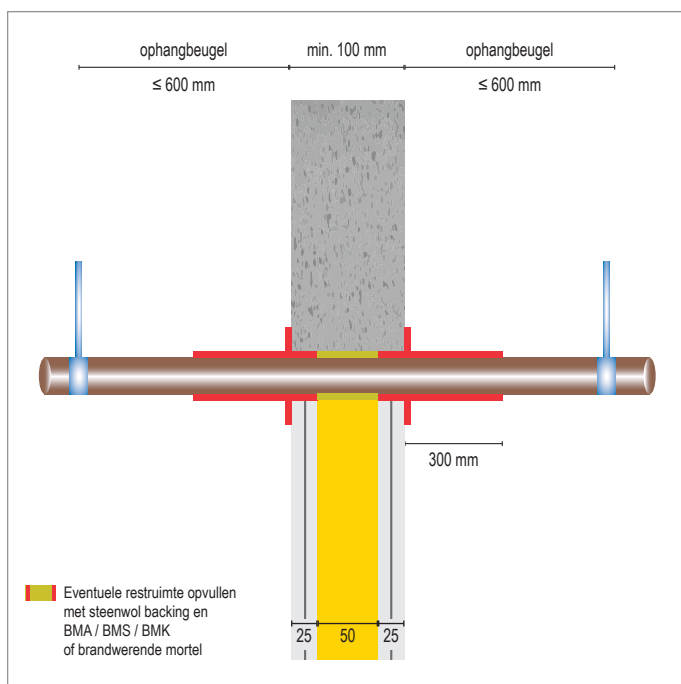



FLAMRO® BMA-BMS-BMK

Ablatieve coating

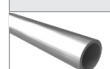
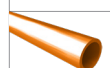

KLEINE SPARING < 40 MM

-  Niet-brandbare Metalen leiding
-  Lichte Scheidingswand
-  Massieve Wand / Massieve Vloer
-  FLAMRO® BMA-BMS-BMK Coating

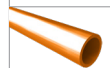
Doorvoer	Diameter (max)	Product	Lengte Coating	Brandweerstandklasse		Goedkeurings document
				Wand	Vloer	
 Staalbuis	≤ 42	BMA 3-4 mm	≥ 300	EI = 60 U/C	EI = 60 U/C	Efectis R0706 Efectis R00996
 Koperbuis	≤ 28	BMA 3-4 mm	≥ 300	EI = 60 U/C	-	Efectis R0706
 Staalbuis	≤ 169	BMA 3-4 mm	≥ 300	EI = 30 U/C	-	Efectis R000731
 Koperbuis	≤ 42	BMA 3-4 mm	≥ 300	EI = 30 U/C	-	Efectis R000731

Deze handleiding dient als ondersteuning voor een juiste montage.
Voor uitgebreide montagedetails, zie *Installation Manual*

Alle maten in mm

Bij afwijkende situaties raadpleeg onze technische support:

 +31 10 72 71 044

 info@svt-products.nl