

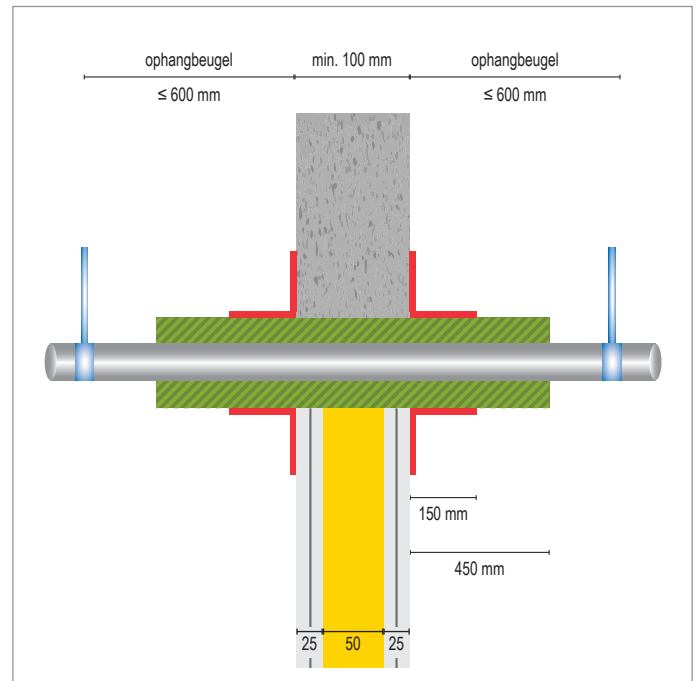

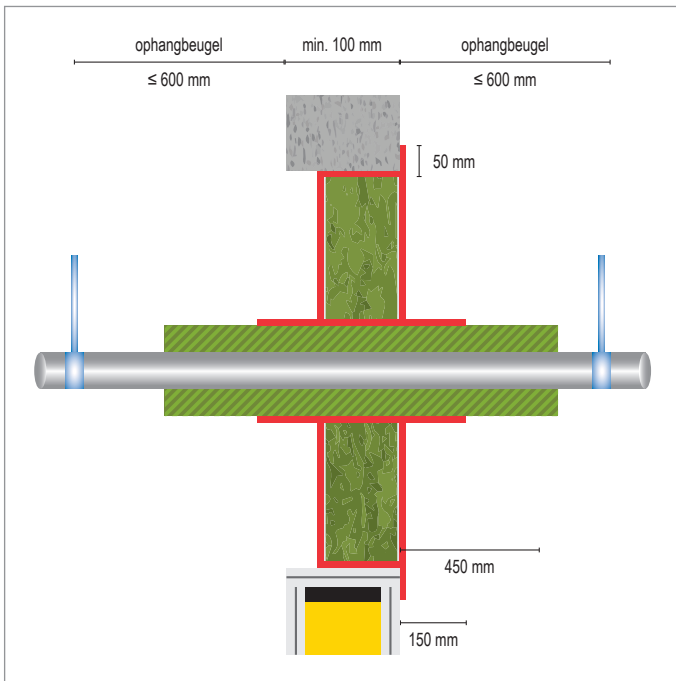



**FLAMRO®**  
**BS 60-2 MK Enkellaags Combischot**  
**BMA-BMS-BMK**



**Fireshell**



**RUIME SPARING ≥ 40 MM**

-  Brandbare Kunststof- of Meerlaagse Aluminium leiding
-  Fireshell
-  Lichte Scheidingswand
-  Massieve Wand
-  FLAMRO® BS 60-2 Combischot
-  FLAMRO® BMA-BMS-BMK Coating

**KLEINE SPARING < 40 MM**

Doorvoer		Diameter (max)	Dikte (max)	Product	Brandweerstandklasse		Goedkeurings document
					Wand	Vloer	
	Kunststof buis	≤ 75	30	Fireshell	EI = 90 C/U	-	Efectis R00706
	Meerlaagse Aluminium buis	≤ 63	30	Fireshell	EI = 90 C/U	-	Efectis R00706

Deze handleiding dient als ondersteuning voor een juiste montage.  
Voor uitgebreide montagedetails, zie *Installation Manual*

Alle maten in mm

Bij afwijkende situaties raadpleeg onze technische support:  
 +31 10 72 71 044       info@svt-products.nl